



YORK® @ Variable Water Flow

Cooling & Heating Solutions



YORK® - A Legacy of Innovation

Trusted in the world's most prestigious buildings for more than 145 years, YORK® make homes, offices and commercial spaces more comfortable and sustainable.

When you have small to medium comfort applications to be cooled and heated you can now count on YORK® Amichi™ Inverter Scroll Air Cooled Chillers for Variable Water Flow (VWF) system.

YORK® @ VWF offers optimum and modular design, higher diversity, higher flexibility, higher reliability and consistent performance over its life cycle.

Sustainable Cooling Solutions using YORK® @ VWF



YORK® YVAG

Air-cooled DC Inverter Scroll Heat Pump

YVAG 012 to 040

A complete range from 11.2 kW up to 40 kW



Features

- High Efficiency
- Built in Pump
- Optimized Low sound
- Cooling & Heating
- Plug & Play
- Factory coated Condenser
- Modular Units: can control up to 4 units up to 160 kW

Technical features

Model		YVAG 012RSE	YVAG 014RSE	YVAG 018RSE	YVAG 025RSE	YVAG 033RSE	YVAG 040RSE	
Performance	Nominal Cooling Capacity	kW	11.2	14	18	25	32	40
	Nominal Heating Capacity	kW	12.6	16.1	19.5	27	34	42
	Sound Power Level	dB(A)	54	55	57	57	59	61
Compressor	Type	Rotary DC Inverter			EVI DC Inverter			
	Quantity	#	1	1	1	1	1	1
Air side heat exchanger	Fan motor type	Brushless DC Fan Motor						
	Fans quantity	#	2	2	2	2	2	2
	Airflow	m³/h	2500-6600			2500-10500		2500-12000
Water side heat exchanger	Type	Brazen Plate Heat Exchanger						
	Pump Type	Multiple-stage centrifugal pump						
	Nominal water flow	m³/h	1.93	2.41	3.10	4.30	5.50	6.88
	Unit external head	m	15	13	11	19	14	14
Dimensions and weight	Height	mm	1320		1588		1700	
	Length	mm	360		400		760	
	Width	mm	995		1100		1300	
	Operating weight	kg	126	128	141	210	215	350
Electrical	Power supply	V/ph/Hz	230V/1ph/50Hz			380/400V-3Ph-50Hz		

Nominal conditions:

Cooling capacities in kW given for 12/7°C water leaving temperature Δt 5°C and 35°C ambient temperature.

Heating capacities in kW given for 40/45°C water leaving temperature and 7°C ambient temperature.

Sound data is tested in YORK lab which may vary according to different installation conditions.

YORK® YMAE

Air-cooled DC Inverter Scroll Heat Pump

YMAE 045 and 065

A complete range from 45 kW to 65 kW



Features

- High Efficiency
- Optional inbuilt pump
- Optimized Low sound
- Cooling & Heating
- Plug & Play
- Factory coated Condenser
- Modular Controls : Up to 32 units can be connected in one system providing wide capacity range (45- 2080 kW)

Technical features

Model		YMAE045XRME	YMAE065XRME	
Performance	Nominal Cooling Capacity	kW	45	65
	Nominal Heating Capacity	kW	46	66
	Sound Power Level	dB(A)	66	68
Compressor	Type	EVI DC Inverter		
	Quantity	#	1	1
Air side heat exchanger	Fan motor type	Brushless DC Fan Motor		
	Fans quantity	#	2	2
	Airflow	m³/h	2500-15000	2500-22000
Water side heat exchanger	Type	Brazen Plate Heat Exchanger		
	Pump Type	Centrifugal pump		
	Nominal water flow	m³/h	7.74	11.19
	Unit external head	m	22	15
Dimensions and weight	Height	mm	1700	1700
	Length	mm	760	760
	Width	mm	1300	1650
	Operating weight	kg	357	430
Electrical	Power supply	V/ph/Hz	380/400V-3Ph-50Hz	

Nominal conditions:

Cooling capacities in kW given for 12/7°C water leaving temperature Δt 5°C and 35°C ambient temperature.

Heating capacities in kW given for 40/45°C water leaving temperature and 7°C ambient temperature.

Sound data is tested in YORK lab which may vary according to different installation conditions.

YORK® YMAA & YMPA

Air-cooled Inverter Scroll Chiller and Heat Pump

YMAA/YMPA 0080 to 0260
A complete range from 78 kW up to 255 kW



Features

- Ultra High Efficiency
- EC Fans for Low sound and High Power Factor
- LCD Touch Screen Panel
- Small Foot Print
- Enhanced Redundancy
- Factory coated Condenser
- Modular Controls : Up to 32 units (16 units for > 130 kW) in one system providing wide capacity range (45- 4080 kW)

Technical features

Model		YMAA/YMPA 0080	YMAA/YMPA 0100	YMAA/YMPA 0130	YMAA/YMPA 0160	YMAA/YMPA 0200	YMAA/YMPA 0230	YMAA/YMPA 0260
Performance	Nominal Cooling Capacity kW	78	99	122	159	188	222	255
	Nominal Heating Capacity kW	87	99	131	161	190	230	255
	Sound Power Level STD/LN dB(A)	81/77	83/79	84/80	86/82	87/82	88/83	89/84
Compressor	Type	DC Scroll Inverter + Scroll						
	Quantity #	3	3	4	5	6	7	8
Air side heat exchanger	Fan motor type	EC Motor						
	Fans quantity #	2	2	2	3	3	4	4
	Airflow m ³ /h	32400	36000	43200	61200	68400	82800	90000
Water side heat exchanger	Type	Brazed Plate Heat Exchanger						
	Pump Type	Multiple-stage centrifugal pump						
	Nominal water flow m ³ /h	13.68	17.28	21.24	26.64	32.76	37.8	42.84
	Unit external head kPa	15	15	15	15	15	15	15
Dimensions and weight	Height mm	2440			2500			
	Length mm	2240			2240			
	Width mm	1200			3050			
	Operating weight kg	141	141	210	210	210	215	215
Electrical	Power supply V/ph/Hz	380/400V-3Ph-50Hz						

YMAA: Cooling only unit models.

YMPA: Air to water heat pump models.

Nominal conditions:

Cooling capacities in kW given for 12/7°C water leaving temperature Δt 5°C and 35°C ambient temperature.

Heating capacities in kW given for 40/45°C water leaving temperature and 7°C ambient temperature.

Sound data is tested in YORK lab which may vary according to different installation conditions.

Dimension & weight data with standard unit without option. Weight might vary with options like Hydronic kit.

YORK® JCHI Chilled Water Hi Wall Unit

JCHI 08 to 20

A complete range from 2.81 kW up to 10.54 kW



Features

- Multi fan speeds for powerful & quiet cooling operation
- Auto swing for good water flow
- Coil with 7mm grooved Copper pipes for high efficiency
- Hydrophilic Aluminum fins for long life
- BMS Compatible
- Optional wall mounted wired remote
- Optional Drain pump for critical applications
- Twin display with wired remote control

Technical features

Model			JCHI08	JCHI10	JCHI15	JCHI20	JCHI25	JCHI30
Performance	Nominal Air Flow ¹	cm/h	697	750	1080	1400	1700	2040
	Cooling Capacity ¹	kW	2.81	3.52	5.28	7.04	8.79	10.54
		TR	0.8	1	1.5	2	2.5	2.84
Electrical	Rated Power Supply	V/Ph/Hz	220-240/1/50					
Motor	Type		BLDC				AC	
	Power ¹	W	18		30	35	60	60
Coil	Tube Information		Copper tube, 7mm Inner Grooved					
	Fin Information		Hydrophilic Coated Aluminium Louvered Fin					
Sound	Pressure Level ²	dBA	44	44	46	49	52	
Dimension & Weight	Width	mm	800		1000	1100	1260	
	Depth	mm	222		230	246	282	
	Height	mm	292		295	329	362	
	Operating Weight	kg	9.3		11	16.5	21.2	

Note : Rated Cooling Conditions: Air Inlet at 27 C-DB / 19.5 C-WB, Chilled Water Inlet / Outlet at 7°C / 12°C

1. Nominal Air Flow, Cooling Capacity and Power consumption value mentioned is at high speed.

2. Sound pressure level is at 1m distance from unit in semi anechoic room at atmospheric conditions.

YORK® Chilled Water 1 Way Cassette Unit



Features

- Ample coil surface area for enhanced cooling performance
- Standard built-in drain pump with 750mm pump head
- Ultra-low height design
- Coil with 7mm grooved copper pipes for high efficiency
- Hydrophilic aluminum fins for longer life
- Sleek hand-held wireless remote for easy operation
- Optional Wall mounted BMS compatible LCD Thermostat

Technical features

Model			JCCT010	JCCT015
Performance	Nominal Air Flow ¹	cm/h	680/515/340	850/660/430
	Cooling Capacity ¹	kW	3.58	4.5
		TR	1	1.3
Electrical	Rated Power Supply	V/Ph/Hz	220-240/1/50	
Motor	Type		AC	
	Power ¹	W	62	73
Coil	Tube Information		Copper tube, 7mm Inner Grooved	
	Fin Information		Hydrophilic Coated Aluminium Louvered Fin	
Sound	Pressure Level ²	dBa	≤ 46	≤ 47
Dimension Body	L x D x H	mm	958 x 413 x 236	
Dimension Panel	L x D x H	mm	1044 x 468 x 31	
Weight	Operating Weight		24.5	

Note : Rated Cooling Conditions: Air Inlet at 27 C-DB / 19.5 C-WB, Chilled Water Inlet / Outlet at 7°C / 12°C

1. Nominal Air Flow, Cooling Capacity and Power consumption value mentioned is at high speed.

2. Sound pressure level is at 1m distance from unit in semi anechoic room at atmospheric conditions.

YORK® Chilled Water 4 Way Cassette Unit



Features

- Standard built-in drain pump with 750mm pump head
- Auto swing for good water flow
- Coil with 7mm grooved copper pipes for high efficiency
- Hydrophilic aluminum fins for longer life
- Optional fresh air inlet

Technical features

Model			JCCT08	JCCT10	JCCT15	JCCT20	JCCT25	JCCT30	JCCT35	JCCT40
Performance	Nominal Air Flow ¹	cm/h	510/440/360	680/580/480	1020/765/510	1360/1020/680	1700/1275/850	2040/1530/1020	2380/1785/1190	2380/1785/1190
	Cooling Capacity ¹	kW	2.81	3.52	5.28	7.04	8.80	10.56	12.30	14.08
		TR	0.8	1	1.5	2	2.5	3	3.5	4
Electrical	Rated Power Supply	V/Ph/Hz	220-240/1/50							
Motor	Type		AC							
	Power ¹	W	55	62	96	134	165	189	225	
Coil	Tube Information		Copper tube, 7mm Inner Grooved							
	Fin Information		Hydrophilic Coated Aluminium Louvered Fin							
Sound	Pressure Level ²	dBa	≤ 39	≤ 42	≤ 45	≤ 46	≤ 48	≤ 50	≤ 52	
Dimension	Width	mm	650		950			950		
	Depth	mm	650		950			950		
	Height	mm	315		345			345		
Weight	Operating Weight		21		29.5	30.5	31.5	33		

Note : Rated Cooling Conditions: Air Inlet at 27 C-DB / 19.5 C-WB, Chilled Water Inlet / Outlet at 7°C / 12°C

1. Nominal Air Flow, Cooling Capacity and Power consumption value mentioned is at high speed.

2. Sound pressure level is at 1m distance from unit in semi anechoic room at atmospheric conditions.

YORK® YGFC Fan Coil Units

YGFC 04 to 14

A complete range from 3.5 kW up to 13.0 kW



Features

- High Efficiency
- AHRI 440 Certified
- Quiet operations
- Low maintenance
- Easy installation

Technical features

Model			YGFC04	YGFC06	YGFC08	YGFC10	YGFC12	YGFC14
Performance	Nominal Air Flow ¹	cm/h	680/580/480	1020/765/510	1360/1020/680	1700/1275/850	2040/1530/1020	2380/1785/1190
	Cooling Capacity ¹	kW	3.5	5.3	7.0	8.8	10.5	13.0
		TR	1.0	1.5	2.0	2.5	3.0	3.7
Electrical	Power Supply	V/Ph/Hz	220-240/1/50					
Fan	Type		Centrifugal fan (Forward curved)					
Motor	Type		AC/BLDC					
	Power ²	W	65/40	80/60	100/80	150/100	200/150	300/200
Coil	Rows	#	2/3/4					
	Fin Information		Corrugated-Louver aluminium fin with hydrophilic coating					
Drain Pan	Type		Press, electrostatic spray coating					
Sound	Pressure Level	dBA	40	47	50	50	52	54
Dimension & Weight	Length	mm	1000	1140	1510	1560	1810	2060
	Width	mm	550	550	550	550	550	550
	Height	mm	250	250	250	250	250	250
	Weight	kg	15	20	25	30	35	40

Note : Rated Cooling Conditions: Air Inlet at 27 C-DB / 19.5 C-WB, Chilled Water Inlet / Outlet at 7°C / 12°C

1. Nominal Air Flow, Cooling Capacity and Power consumption value mentioned is at high speed.

2. The Power Input of 230V/50Hz AC motors are the same with that of 220V / 50 Hz AC motors.

Johnson Controls 2 way / 3 way ON-OFF Valves

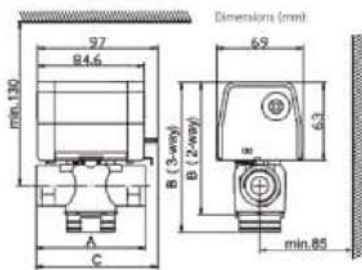

Features

- Precision Control
- Maintains Room temperature
- Saves energy by precision control
- Spring return function

Technical features

Model	DN Size	Type	Kv (Cv)	Close-off Pressure	Weight (g)	Dimensions (mm)		
						A	B	C
VLC2200FC-C	DN15	2-way	1.7 (2.0)	0.45 MPa (65PSI)	700	70	106	91
VLC2200GC-C	DN20	2-way	2.2 (2.5)	0.35 MPa (50PSI)	850	87	106	99
VLC2200HC-C	DN25	2-way	3.0 (3.5)	0.20 MPa (30PSI)	1000	95.5	112	103
VLC2300FC-C	DN15	3-way	1.7 (2.0)	0.45 MPa (65PSI)	750	70	115	91
VLC2300GC-C	DN20	3-way	2.6 (3.0)	0.35 MPa (50PSI)	900	87	120	99
VLC2300HC-C	DN25	3-way	3.4 (4.0)	0.20 MPa (30PSI)	1050	95.5	128	103

Johnson Controls PICV Valves

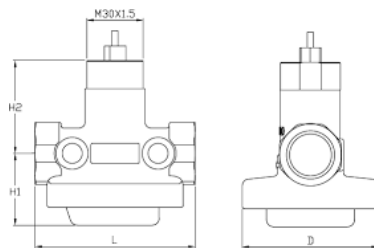

Features

- Specific devices are not necessary
- Wide range of operating differential pressure
- Compact design that allows installation in small spaces such as fan-coils or narrow supply spaces
- Simple flow rate adjustment
- Dirty resistance allows long life characteristic
- Pressure ports selectable

Technical features

Model	DN Size	Flow rate max (m³/h)	Stroke (mm)	Start-up max. (kPa)	P max. (kPa)	Pressure Ports
VPMF7015-C	DN15	0.9	4	35	500	No
VPMF7020-C	DN20	1.3	4	35	500	No
VPMF7025-C	DN25	2.0	4	35	500	No
VPMF7015P-C	DN15	0.9	4	35	500	Yes
VPMF7020P-C	DN20	1.3	4	35	500	Yes
VPMF7025P-C	DN25	2.0	4	35	500	Yes

DN	L (mm)	D (mm)	H1 (mm)	H2 (mm)	Weight (kg)
15	74	62	34	46.5	0.6
20	80	68	36	46.5	0.8
25	85	69	42.5	46.5	0.9

Johnson Controls ON-OFF Actuators

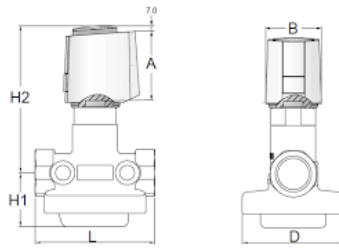

Features

- Available for wide range of power requirements
- Easy installation
- Compact design
- IP 54 rated
- Feedback control

Technical features

DN	L (mm)	D (mm)	H1 (mm)	H2 (mm)	A (mm)	B (mm)
15	74	62	34	104	53	44.3
20	80	68	36	104	53	44.3
25	85	69	42.5	104	53	44.3

Johnson Controls Proportional Actuators – PICV

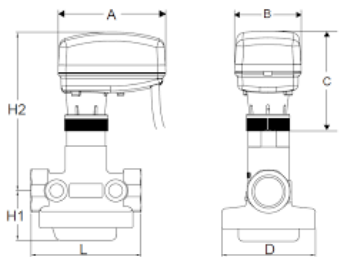

Features

- 24 VAC/VDC and 230 VAC power supply
- Floating and proportional control
- Threaded nut M28x1.5 and M30x1.5
- Auto stroke detection
- Configurable stroke
- Configurable to direct and reverse action
- Configurable analog inputs
- Max mechanical stroke 6.3 mm
- Feedback control

Technical features

DN	L (mm)	D (mm)	H1 (mm)	H2 (mm)	A (mm)	B (mm)	C (mm)
15	74	62	34	115	80	49	73.6
20	80	68	36	115	80	49	73.6
25	85	69	42.5	115	80	49	73.6

Johnson Controls Thermostat



Features

- Large backlit LCD
- Intuitive and clear interface
- Retain parameter setting after power loss
- Easy operation

Technical features

DN	L (mm)	D (mm)	H1 (mm)	H2 (mm)	A (mm)	B (mm)
15	74	62	34	104	53	44.3
20	80	68	36	104	53	44.3
25	85	69	42.5	104	53	44.3

Benefits of YORK® @ VWF



Key Technology and Performance	YORK® @ VWF	VRF
Inverter Compressor	Yes	Yes
BLDC inverter / EC Fan Motor	Yes	Yes
Various indoor units	Yes	Yes
Cooling Operation with Ducted Indoor Units	Yes	Yes
Heating Operation with Ducted Indoor Units	Yes	Yes
Under-floor Heating	Yes	(HR or Split Type)
Connected Capacity Ratio Limitation	No	50%-130%
Limitation on Number of connected IDUs	No	Yes
Capacity deration due to long piping length	No	Yes (10%-20%)
The installation method for integrating the system	Glue or Thread	Brazing
Risk of water / refrigerant leakage in the room	Low (0.6MPa)	High (2.8-3.0MPa)
Option of scalability on IDU capacity	Yes	No
Caution for refrigerant leaks	No	Yes (concentration)
BMS Compatibility	Standard	Optional
Cooling Medium	Water	HFC Refrigerant



About Johnson Controls

At Johnson Controls, we transform the environments where people live, work, learn and play. From optimizing building performance to improving safety and enhancing comfort, we drive the outcomes that matter most. We deliver our promise in industries such as healthcare, education, data centers and manufacturing. With a global team of 105,000 experts in more than 150 countries and over 130 years of innovation, we are the power behind our customers' mission.

Our leading portfolio of building technology and solutions includes some of the most trusted names in the industry, such as Tyco®, YORK®, Metasys®, Ruskin®, Titus®, Frick®, Penn®, Sabroe®, Simplex®, Ansul® and Grinnell®.

For additional information, please visit www.johnsoncontrols.com/en or follow us [@johnsoncontrols](https://twitter.com/johnsoncontrols) on Twitter.

Johnson Controls

B2, 3rd Floor, Cerebrum IT Park,
Kumar city, Kalyani Nagar,
Pune, Maharashtra 411014. India

E-mail: BTS-India-Channelsales@jci.com

© 2023 Johnson Controls · All rights reserved.